

# ERGOCUT CB 100

P L A S M A   R A N G E

## TECHNICAL DATA

Voltage class	M
Standard length m	6
Air consumption	180 l/min
Air pressure	5 bar
Duty cycle 60%	100 A
Duty cycle 100%	70 A

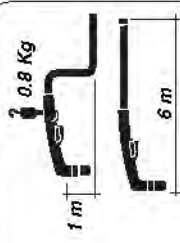

	CB 100	m		CB 100 P	m
	<b>FITTING</b> 7/8 G	6	<b>FITTING</b> 7/8 G	PA1216	6
	Central adaptors	6		PA1219	6

### DECLARATION OF CONFORMITY

The undersigned company Trafimet - Via del Lavoro, 8 - 36020 Castegnero (VI) - Italy - declares that the product identified and described on this page complies with standard EN 60974-7 in accordance with the requirements contemplated by directive EEC 73/23 low voltage.



EN 60974-7

**trafimet**  
your welding partner

# ERGOCUT CB 100

PLASMA RANGE

**trafimet**

your welding partner

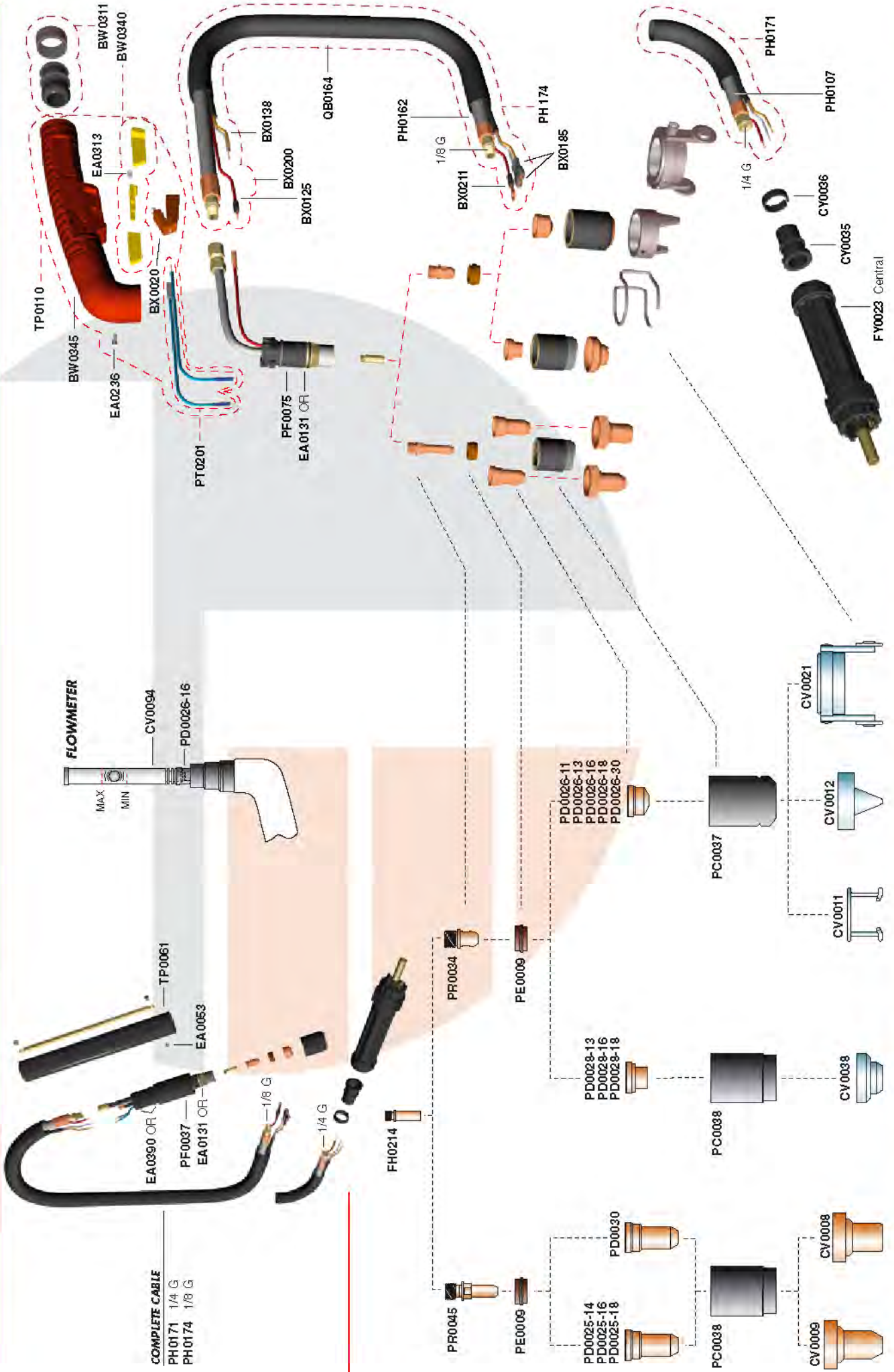

## PLASMATOORTS ERGOCUT CB 100

Leverancier	artikelnummer Tramex	Omschrijving	Type
PA1350	<b>2542650542</b>	Plasma snijtoorts 6M 1/8	Ergocut CB100
PA1352	<b>2542650543</b>	Plasma snijtoorts 6M cen	Ergocut CB 100
FH0214	<b>2552650553</b>	Dompelpijpje	CB100 1378
PR0034	<b>2552650496</b>	Electrode kort	CB100+150 1376
PE0009	<b>2552650498</b>	Luchtverdelers	CB100+150 1377
PD0028-13	<b>2552650509</b>	Snij-kontakt-mondst. 1.35	CB100+150
PD0028-16	<b>2552650510</b>	Snij-kontakt-mondst. 1.60	CB100+150
PD0028-18	<b>2552650511</b>	Snij-kontakt-mondst. 1.8	CB100+150
PC0038	<b>2552650568</b>	Gasmondstuk	CB100
CV0038	<b>2552650513</b>	Afstand-kontakt-stuk	CB150
PR0034	<b>2552650496</b>	Electrode kort	CB100+150 1376
PD0026-11	<b>2552650499</b>	Snijmondstuk 1.1	CB100+150 1371
PD0026-13	<b>2552650500</b>	Snijmondstuk	CB100+150 1372
PD0026-16	<b>2552650501</b>	Snijmondstuk	CB100+150 1373
PD0026-18	<b>2552650502</b>	Snijmondstuk	CB100+150 1374
PD0026-30	<b>2552650503</b>	Gutsmondstuk 3.0	CB150 1375
PC0037	<b>2552650567</b>	Gasmondstuk	CB100
CV0011	<b>2522632312</b>	Afstandsveer	Diverse toortsen
CV0012	<b>2522632313</b>	Afstandsbus 2-poots	Diverse toortsen
CV0021	<b>2522632321</b>	Snijwagen	Diverse toortsen
PR0045	<b>2552650497</b>	Electrode lang HF	CB100+150 1517
PE0009	<b>2552650498</b>	Luchtverdelers	CB100+150 1377
PD0025-14	<b>2552650593</b>	Snijmondstuk 90A	CB100+150
PD0025-16	<b>2552650594</b>	Snijmondstuk 120A	CB100+150
PD0025-18	<b>2552650595</b>	Snijmondstuk 150A	CB100+150
PD0030	<b>2552650504</b>	Snijmondstuk lang 50A	CB100+150 1369
PC0038	<b>2552650568</b>	Gasmondstuk	CB100
CV0009	<b>2522632349</b>	Afst.cup-kontaktsnijden	A101+A141+A151
CV0008	<b>2522632348</b>	Afst.cup-kontaktsnijden	A101+A141+A151
TP0110	<b>2522632240</b>	Handgreep Kpl.	A81+A101+A141+A151
PF0075	<b>2552650623</b>	Branderlichaam	Ergocut CB 100
EA0131	<b>2522632302</b>	O-Ring	Diverse toortsen
BW0345	<b>2522632243</b>	Handgreep, los	A81+A101+A141+A151
EA0236	<b>2522632064</b>	Inzetschroeven handgreep	Diverse plasma
BX0020	<b>2162609021</b>	Drukschakelaar	Diverse toortsen
EA0313	<b>2522632214</b>	Veer	Diverse plasma
BW0340	<b>2522632213</b>	Beveiliging tbv schakelaa	A81+A101+A141+A151
BW0311	<b>2342640210</b>	Kogelgewricht + ring	Diverse toortsen
PT0201	<b>2522632269</b>	Reparatieset plasmatoorts	A81+A101+A141+A151
BX0125	<b>2552650298</b>	Kabelpilotboog	CB 50
BX0200	<b>2202611330</b>	Stekker	MEGA 2+3+4+5
BX0138	<b>2522632079</b>	Controle kabel	S 45
QB0164	<b>2552650577</b>	Beschermhoes	CB100
PH0162	<b>2552650588</b>	Stroom-luchtkabel 6M	CB100+150
BX0211	<b>2552650299</b>	Nippel	CB 50
BX0185	<b>2552650403</b>	Stekker V	CB 70
PH0174	<b>2552650569</b>	Toortspakket 6M	CB100

## PLASMATOORTS ERGOCUT CB 100

Leverancier	artikelnummer Tramex	Omschrijving	Type
PH0107	<b>2522632445</b>	Stroom-luchtkabel 6mtr.	A 141
PH0171	<b>2552650565</b>	Toortspakket 6M	CB100P
CY0036	<b>2522632444</b>	Vulring	A141+A151
CY0035	<b>2522632443</b>	Buigbescherming handgreep	A141+A151
FY0023	<b>2522632130</b>	C.A. 5-pins Kpl. T.Z.	Diverse plasma
CV0094	<b>2552650521</b>	Flowmeter	CB150
CV0022	<b>2522632322</b>	Snijwagen-passer-set	Diverse toortsen

## PLASMATOORTS ERGOCUT CB 100 P

artikelnummer Leverancier	Tramex	Omschrijving	Type
PA1216	<b>2542650546</b>	Plasma aut.toorts 6M 1/8	CB100P
PA1219	<b>2542650547</b>	Plasma aut.toorts 6M cen	CB100P
FH0214	<b>2552650553</b>	Dompelpijpje	CB100 1378
PR0034	<b>2552650496</b>	Electrode kort	CB100+150 1376
PE0009	<b>2552650498</b>	Luchtverdeler	CB100+150 1377
PD0028-13	<b>2552650509</b>	Snij-kontakt-mondst. 1.35	CB100+150
PD0028-16	<b>2552650510</b>	Snij-kontakt-mondst. 1.60	CB100+150
PD0028-18	<b>2552650511</b>	Snij-kontakt-mondst. 1.8	CB100+150
PC0038	<b>2552650568</b>	Gasmondstuk	CB100
PR0034	<b>2552650496</b>	Electrode kort	CB100+150 1376
PD0026-11	<b>2552650499</b>	Snijmondstuk 1.1	CB100+150 1371
PD0026-13	<b>2552650500</b>	Snijmondstuk	CB100+150 1372
PD0026-16	<b>2552650501</b>	Snijmondstuk	CB100+150 1373
PD0026-18	<b>2552650502</b>	Snijmondstuk	CB100+150 1374
PD0026-30	<b>2552650503</b>	Gutsmondstuk 3.0	CB150 1375
PC0037	<b>2552650567</b>	Gasmondstuk	CB100
PR0045	<b>2552650497</b>	Electrode lang HF	CB100+150 1517
PE0009	<b>2552650498</b>	Luchtverdeler	CB100+150 1377
PD0025-14	<b>2552650593</b>	Snijmondstuk 90A	CB100+150
PD0025-16	<b>2552650594</b>	Snijmondstuk 120A	CB100+150
PD0025-18	<b>2552650595</b>	Snijmondstuk 150A	CB100+150
PD0030	<b>2552650504</b>	Snijmondstuk lang 50A	CB100+150 1369
PC0038	<b>2552650568</b>	Gasmondstuk	CB100
PF0037	<b>2552650602</b>	Aut.brandertlichaam recht	CB100P
EA0131	<b>2522632302</b>	O-Ring	Diverse toortsen
TP0061	<b>2522632281</b>	Handgreep	Diverse toortsen
FH0158	<b>2522632285</b>	Tandheugel	Diverse toortsen
PH0171	<b>2552650565</b>	Toortspakket 6M	CB100P
PH0174	<b>2552650569</b>	Toortspakket 6M	CB100
CV0094	<b>2552650521</b>	Flowmeter	CB150